

REV	DESCRIPTION	DATE
2.00	CHG INSULATOR INNER DESIGN (HALF AIR)	2018/01/15
2.10	NEW DRAWING FRAME	2024/01/02

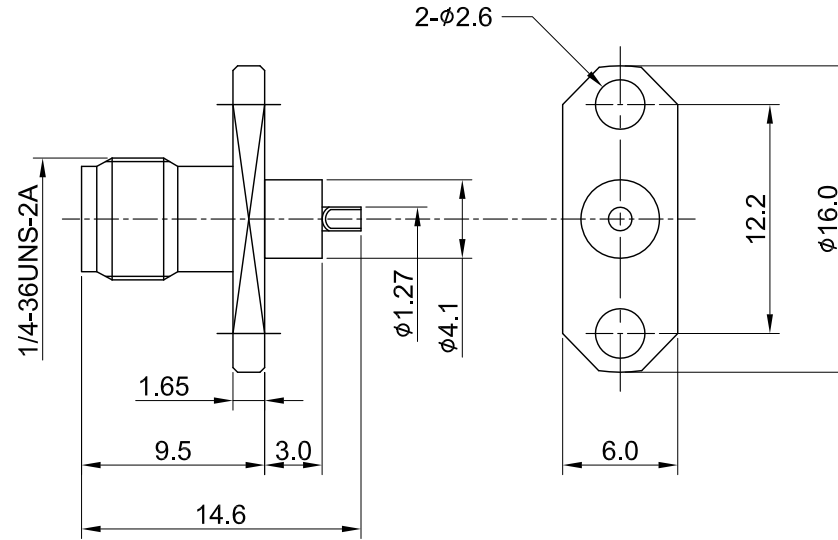

MECHANICAL DATA  
 DURABILITY : 500 CYCLES  
 TEMPERATURE RANGE : -65°C ~ + 165°C

ELECTRICAL DATA  
 FREQUENCY RANGE: DC~6GHz  
 IMPEDANCE : 50Ω  
 VSWR : 1.3 MAX.  
 WORKING VOLTAGE : AC 500V  
 WITHSTANDING VOLTAGE : AC 1000V  
 INSULATION RESISTANCE : 5000 MΩ MIN

04	INSULATOR B	TEFLON	NONE	1
03	CENTER PIN	Be.Cu	GOLD	1
02	INSULATOR A	TEFLON	NONE	1
01	BODY	BRASS	GOLD	1
NO	DESCRIPTION	MATERIAL	FINISH	Q'TY

TITLE  
 SMA(F) 2holes panel mount w/extended 3.0mm PTFE, solder cup

DWG NO.  
 C02AQ3139



CUST.  
 P/N: N/A  
 DWG NO: N/A

GENERAL TOLERANCES  
 .X ±0.2  
 .XX ±0.2  
 .XXX ±0.2  
 ANGLES N/A

DRAWN BY: Kelly 2024/01/02  
 CHK'D BY: Maria 2024/01/02



REV.  
 2.10

SHEET 1 of 1 Unit: mm

DA2312260050