

REV	DESCRIPTION	DATE
2.00	CHG SLEEVE FINISH NICKEL w. COPPER-TIN-ZINC	2011/09/08
2.10	NEW DRAWING FRAME	2023/12/20

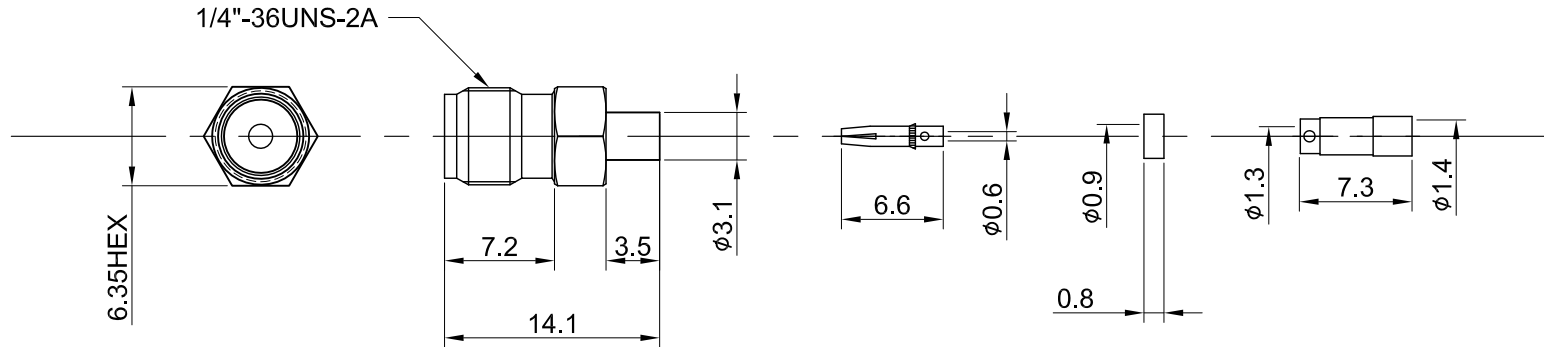
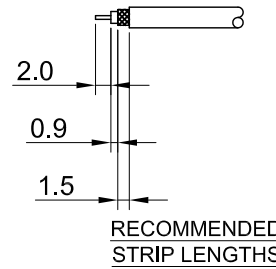

MECHANICAL DATA
 DURABILITY : 500 CYCLES
 TEMPERATURE RANGE : -65°C ~ + 165°C

ELECTRICAL DATA
 FREQUENCY RANGE: DC ~ 6GHz
 IMPEDANCE : 50Ω
 VSWR : 1.3 MAX.
 WORKING VOLTAGE : AC 170V
 WITHSTANDING VOLTAGE : AC 500V
 INSULATION RESISTANCE : 5000 MΩ MIN

TITLE
 SMA Straight Jack Crimp for 1.37 Cable

05	INSULATOR B	TEFLON	NONE	1
04	SLEEVE	BRASS	NICKEL	1
03	INSULATOR A	TEFLON	NONE	1
02	PIN	Be Cu	GOLD	1
01	BODY	BRASS	GOLD	1
NO	DESCRIPTION	MATERIAL	FINISH	Q'TY

DWG NO.
C02AA31137012C

CUST.
P/N: N/A
DWG NO: N/A

SHEET 1 of 1 Unit: mm

Wellshow

GENERAL TOLERANCES
 .X ±0.2
 .XX ±0.2
 .XXX ±0.2
 ANGLES N/A

DRAWN BY: Lottie 2023/12/20
 CHK'D BY: Kelly 2023/12/20

REV. 2.10

DA2312150035