

REV	DESCRIPTION	DATE
A	INITIAL DESIGN	2011/03/29
1.10	NEW DRAWING FRAME	2024/07/08

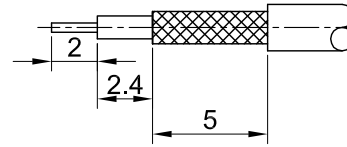

RECOMMENDED STRIP LENGTHS

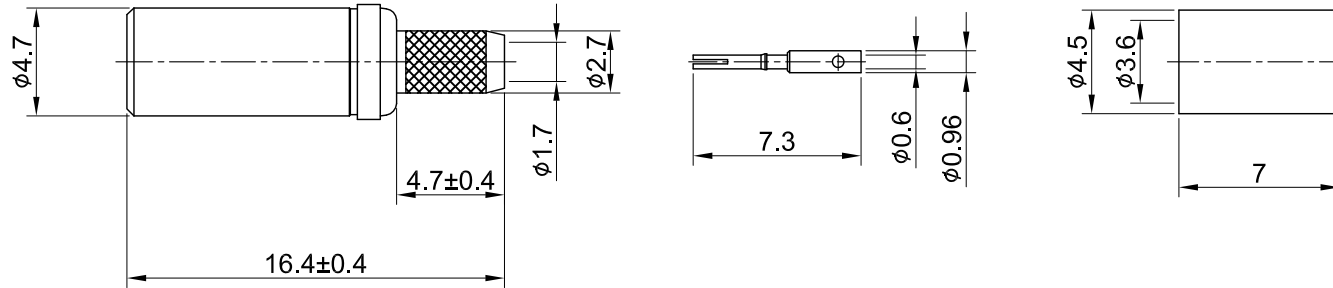

MECHANICAL DATA
 DURABILITY : 500 CYCLES
 TEMPERATURE RANGE : -65°C ~ + 165°C

ELECTRICAL DATA
 FREQUENCY RANGE: DC~4GHz
 IMPEDANCE : 50Ω
 VSWR : 1.5 MAX.
 WORKING VOLTAGE : AC 175V
 WITHSTANDING VOLTAGE : AC 500V
 INSULATION RESISTANCE : 1000 MΩ MIN

06	FERRULE	BRASS	GOLD	1
05	BODY B	P.BRONZE	GOLD	1
04	SHELL	BRASS	GOLD	1
03	CENTER PIN	Be.Cu	GOLD	1
02	INSULATOR	TEFLON	NONE	1
01	BODY A	BRASS	GOLD	1
NO	DESCRIPTION	MATERIAL	FINISH	Q'TY

TITLE		DRAWN BY:		CHK'D BY:		REVISION	
SSMB st. plug crimp for RD316		Kelly		Chili		REV.	
DWG NO. C11AA3F316D02		2024/07/08		2024/07/08		1.10	
CUST. P/N: N/A DWG NO: N/A		GENERAL TOLERANCES		DRAWN BY:		CHK'D BY:	
SHEET 1 of 1 Unit: mm		.X ±0.2 .XX ±0.2 .XXX ±0.2 ANGLES N/A		DA		1.10	

