

REV	DESCRIPTION	DATE
1.20	NEW DRAWING FRAME	2023/09/28

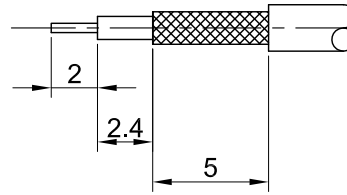

RECOMMENDED STRIP LENGTHS

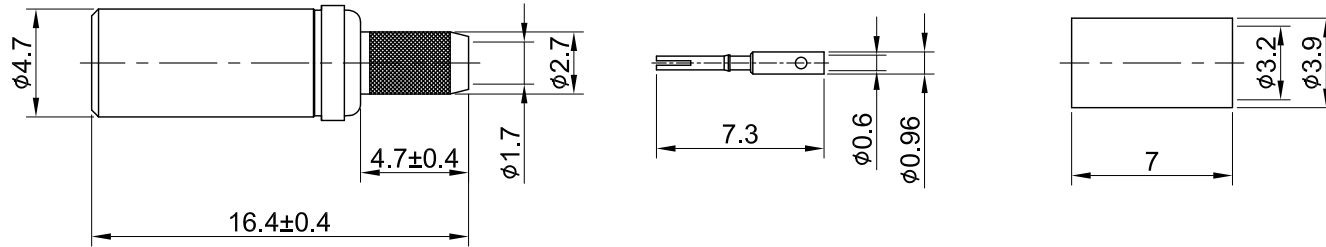

MECHANICAL DATA  
 DURABILITY : 500 CYCLES  
 TEMPERATURE RANGE : -65°C ~ + 165°C

ELECTRICAL DATA  
 FREQUENCY RANGE: DC~4GHz  
 IMPEDANCE : 50Ω  
 VSWR : 1.5 MAX.  
 WORKING VOLTAGE : AC 175V  
 WITHSTANDING VOLTAGE : AC 500V  
 INSULATION RESISTANCE : 1000 MΩ MIN

06	FERRULE	BRASS	GOLD	1
05	BODY B	P.BRONZE	GOLD	1
04	SHELL	BRASS	GOLD	1
03	CENTER PIN	Be.Cu	GOLD	1
02	INSULATOR	TEFLON	NONE	1
01	BODY A	BRASS	GOLD	1
NO	DESCRIPTION	MATERIAL	FINISH	Q'TY

TITLE		DRAWN BY:		CHK'D BY:		REVISION	
SSMB (M) st. crimp type for RG174		Kelly		David		2023/09/28	
DWG NO. C11AA3F174002		CUST. P/N: N/A		DWG NO: N/A		GENERAL TOLERANCES: .X ±0.2, .XX ±0.2, .XXX ±0.2, ANGLES N/A	
SHEET 1 of 1		Unit: mm		DA2309280034		REV. 1.20	

