

REV	DESCRIPTION	DATE
2.10	NEW DRAWING FRAME	2023/06/29
2.20	CORRECT INSULATION RESISTANCE	2023/11/15

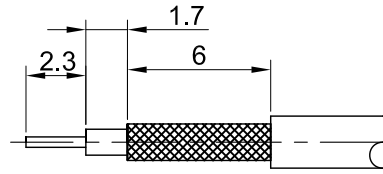

RECOMMENDED STRIP LENGTHS

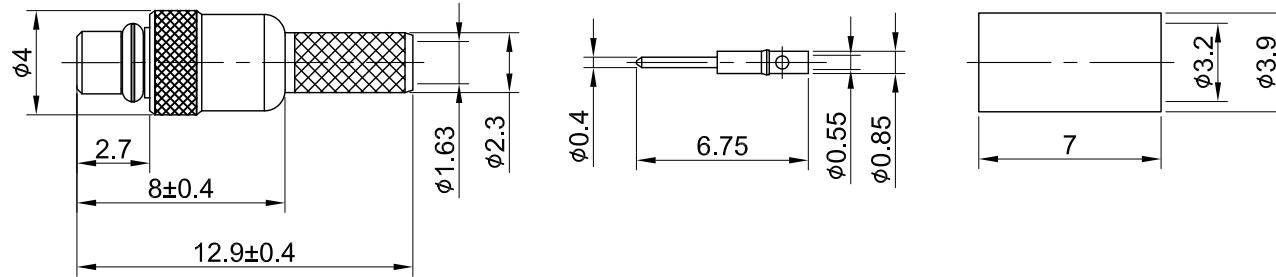

MECHANICAL DATA
TEMPERATURE RANGE : -65°C ~ + 165°C

ELECTRICAL DATA
FREQUENCY RANGE: DC~6GHz
IMPEDANCE : 50Ω
VSWR : DC~3GHz : 1.3 MAX.
3.01~6GHz : 1.5 MAX.
WORKING VOLTAGE : AC 170V
WITHSTANDING VOLTAGE : AC 500V
INSULATION RESISTANCE : 1000 MΩ MIN

06	BODY B	BRASS	GOLD	1
05	RING	Be.Cu	GOLD	1
04	INSULATOR	TEFLON	NONE	1
03	BODY A	BRASS	GOLD	1
02	PIN	BRASS	GOLD	1
01	FERRULE	BRASS	GOLD	1
NO	DESCRIPTION	MATERIAL	FINISH	Q'TY

TITLE		DRAWN BY:		DATE	
MMCX(M) st. crimp type for RD316		Lottie	2023/11/15		
DWG NO. C05AA3F316D03		CHK'D BY:	Kana	2023/11/15	
CUST. P/N: N/A DWG NO: N/A		GENERAL TOLERANCES		REV.	
SHEET 1 of 1		.X ±0.2		DA2311140024	
Unit: mm		.XX ±0.2		2.20	
		.XXX ±0.2			
		ANGLES N/A			

