

REV	DESCRIPTION	DATE
1.00	INITIAL DESIGN	2017/08/03
1.10	CHG 1.7 W. 2.6, INSULATOR A PET W. POM	2023/05/18
1.11	UPDATE TEMPERATURE RANGE	2023/08/04
1.20	CORRECT INSULATION RESISTANCE	2023/11/08

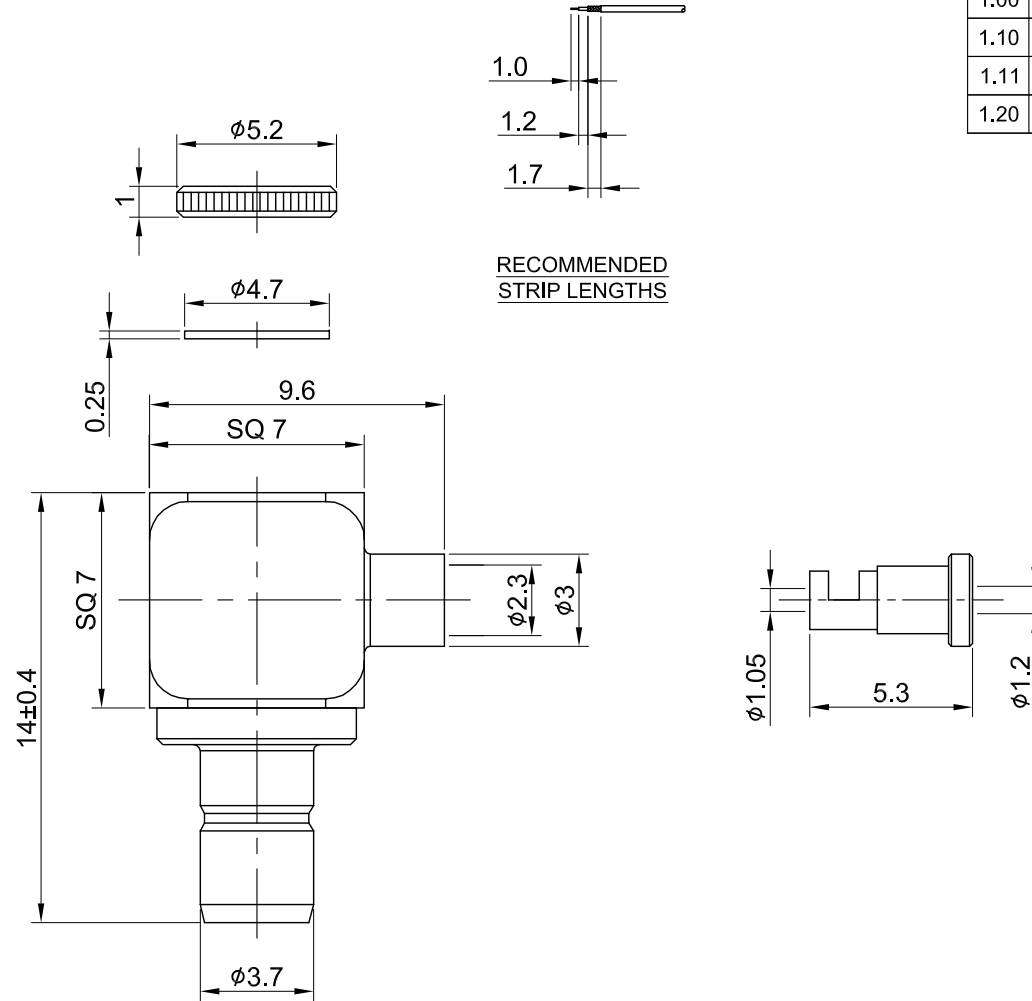

MECHANICAL DATA  
TEMPERATURE RANGE : -40°C ~ + 85°C

DIELECTRICAL DATA  
FREQUENCY RANGE: DC~4GHz  
IMPEDANCE : 50Ω  
VSWR : 1.5 MAX.  
WORKING VOLTAGE : AC 335V  
WITHSTANDING VOLTAGE : AC 750V  
INSULATION RESISTANCE : 1000 MΩ MIN

07	FERRULE	BRASS	GOLD	1
06	BODY B	BRASS	GOLD	1
05	INSULATOR B	TEFLON	NONE	1
04	CENTER PIN	BRASS	GOLD	1
03	BODY A	BRASS	GOLD	1
02	INSULATOR A	PET	NONE	1
01	COVER	BRASS	GOLD	1
NO	DESCRIPTION	MATERIAL	FINISH	Q'TY

TITLE		DRAWN BY:		DATE
SMB(F)ra. crimp for 1.13		Lottie		2023/11/08
DWG NO. C04BA3F113011A		CHK'D BY:		2023/11/08
CUST. P/N: N/A DWG NO: N/A		Kana		REV. 1.20
SHEET 1 of 1		Unit: mm		DA2311060015



GENERAL TOLERANCES		DRAWN BY:		DATE
.X	±0.2	Lottie		2023/11/08
.XX	±0.2	CHK'D BY:		2023/11/08
.XXX	±0.2	Kana		REV. 1.20
ANGLES	N/A	DA2311060015		