

REV	DESCRIPTION	DATE
1.00	INITIAL DESIGN	2023/05/17
1.01	UPDATE TEMPERATURE RANGE	2023/08/04
1.10	CORRECT INSULATION RESISTANCE	2023/11/08

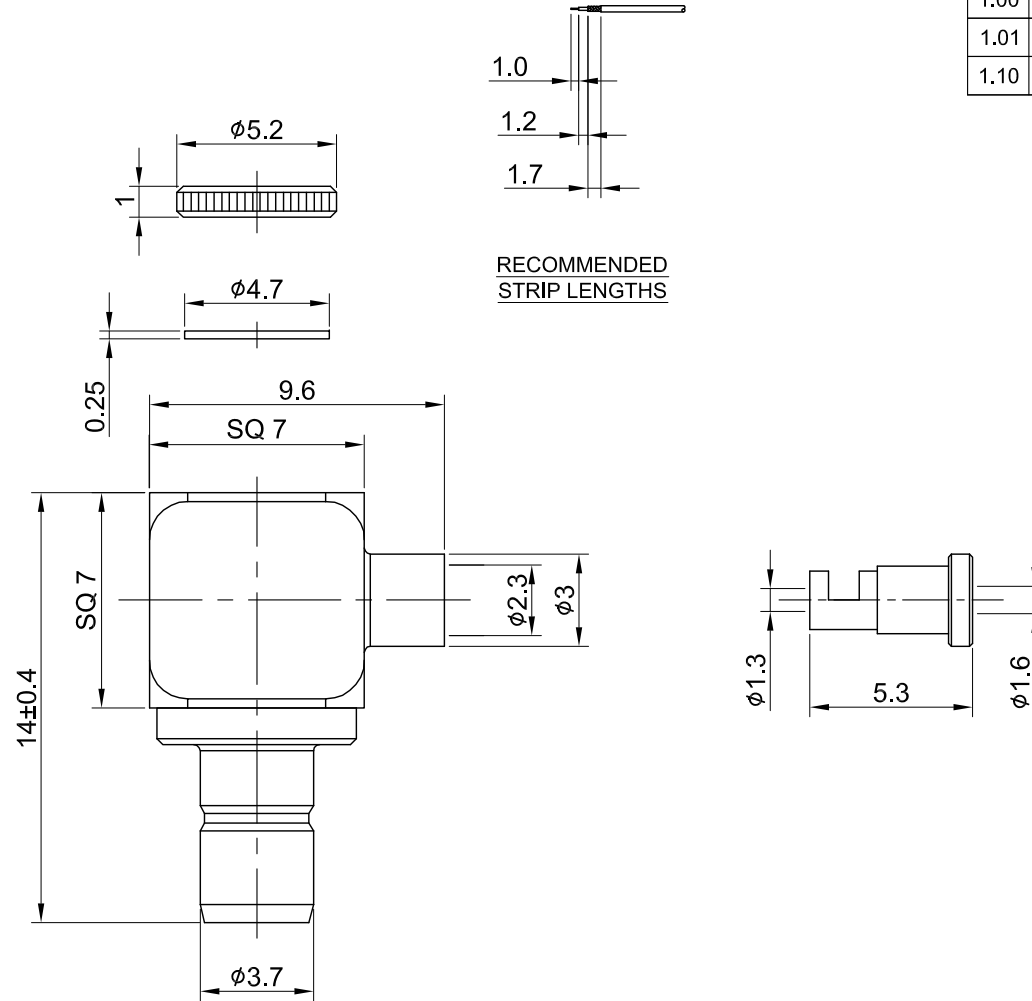

MECHANICAL DATA
 TEMPERATURE RANGE : -40°C ~ + 85°C

DIELECTRICAL DATA
 FREQUENCY RANGE: DC~4GHz
 IMPEDANCE : 50Ω
 VSWR : 1.5 MAX.
 WORKING VOLTAGE : AC 335V
 WITHSTANDING VOLTAGE : AC 750V
 INSULATION RESISTANCE : 1000 MΩ MIN

07	FERRULE	BRASS	GOLD	1
06	BODY B	BRASS	GOLD	1
05	INSULATOR B	TEFLON	NONE	1
04	CENTER PIN	BRASS	GOLD	1
03	BODY A	BRASS	GOLD	1
02	INSULATOR A	PET	NONE	1
01	COVER	BRASS	GOLD	1
NO	DESCRIPTION	MATERIAL	FINISH	Q'TY

TITLE		DRAWN BY:		DATE
SMB(F)ra. crimp for 1.37		Lottie	2023/11/08	
DWG NO. C04BA3F137011A		CHK'D BY:	Kana	2023/11/08
CUST. P/N: N/A DWG NO: N/A				REV. 1.10
SHEET 1 of 1	Unit: mm	DA2311060020		



GENERAL TOLERANCES	
.X	±0.2
.XX	±0.2
.XXX	±0.2
ANGLES	N/A