

REV	DESCRIPTION	DATE
1.00	INITIAL DESIGN	2017/08/01
1.10	CHG 1.7 W. 2.6, INSULATOR A PET W. POM	2023/05/18
1.11	UPDATE TEMPERATURE RANGE	2023/08/04
1.20	CORRECT INSULATION RESISTANCE	2023/11/09

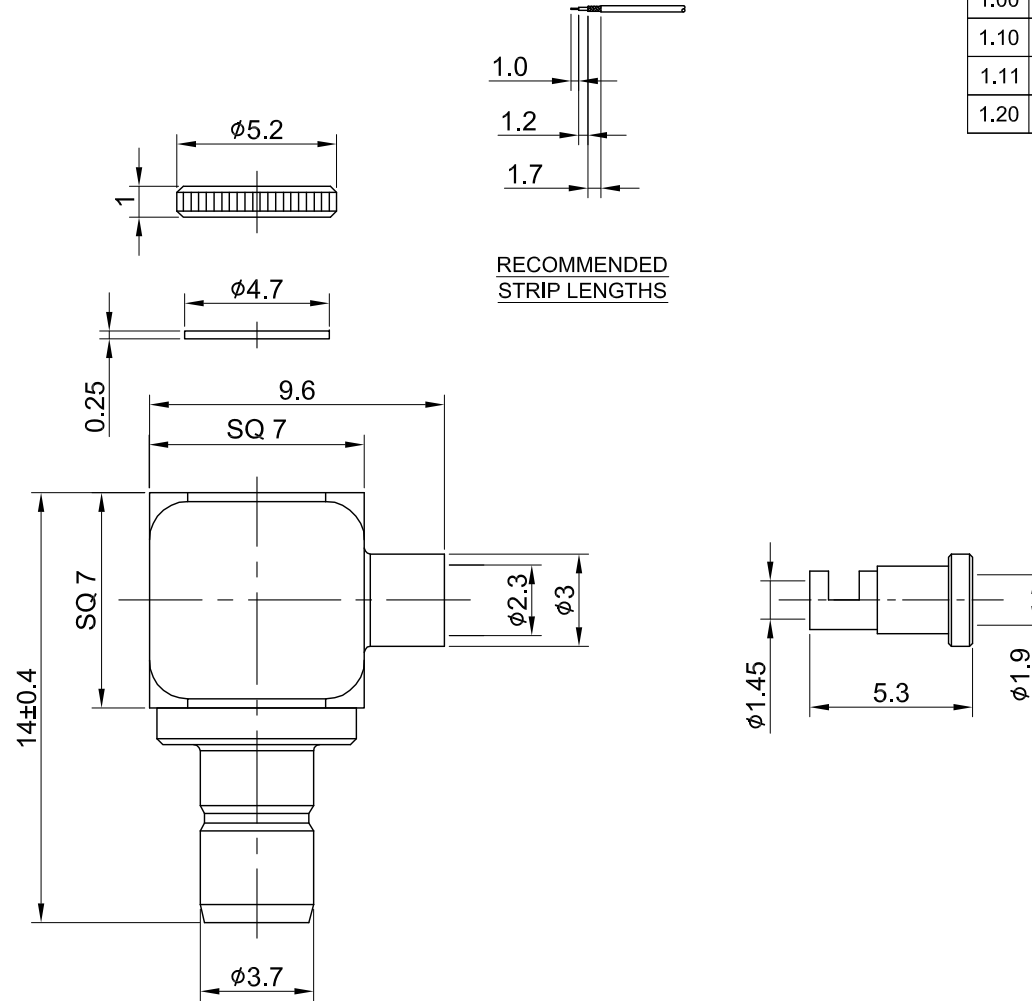

MECHANICAL DATA  
TEMPERATURE RANGE : -40°C ~ + 85°C

DIELECTRICAL DATA  
FREQUENCY RANGE: DC~4GHz  
IMPEDANCE : 50Ω  
VSWR : 1.5 MAX.  
WORKING VOLTAGE : AC 335V  
WITHSTANDING VOLTAGE : AC 750V  
INSULATION RESISTANCE : 1000 MΩ MIN

NO	DESCRIPTION	MATERIAL	FINISH	Q'TY	TITLE	
07	FERRULE	BRASS	GOLD	1	SMB(F)ra. crimp for RG178	
06	BODY B	BRASS	GOLD	1	DWG NO. C04BA3F178011A	
05	INSULATOR B	TEFLON	NONE	1	CUST. P/N: N/A DWG NO: N/A	
04	CENTER PIN	BRASS	GOLD	1	GENERAL TOLERANCES: .X ±0.2, .XX ±0.2, .XXX ±0.2, ANGLES N/A	
03	BODY A	BRASS	GOLD	1	DRAWN BY: Lottie 2023/11/09	
02	INSULATOR A	PET	NONE	1	CHK'D BY: Kana 2023/11/09	
01	COVER	BRASS	GOLD	1	REV. 1.20	
NO	DESCRIPTION	MATERIAL	FINISH	Q'TY	SHEET 1 of 1	Unit: mm



DA2311060028