

REV	DESCRIPTION	DATE
1.30	CHG 1.2/ 0.3 W. 0.7/0.8	2023/08/02
1.40	CORRECT INSULATION RESISTANCE	2023/11/14

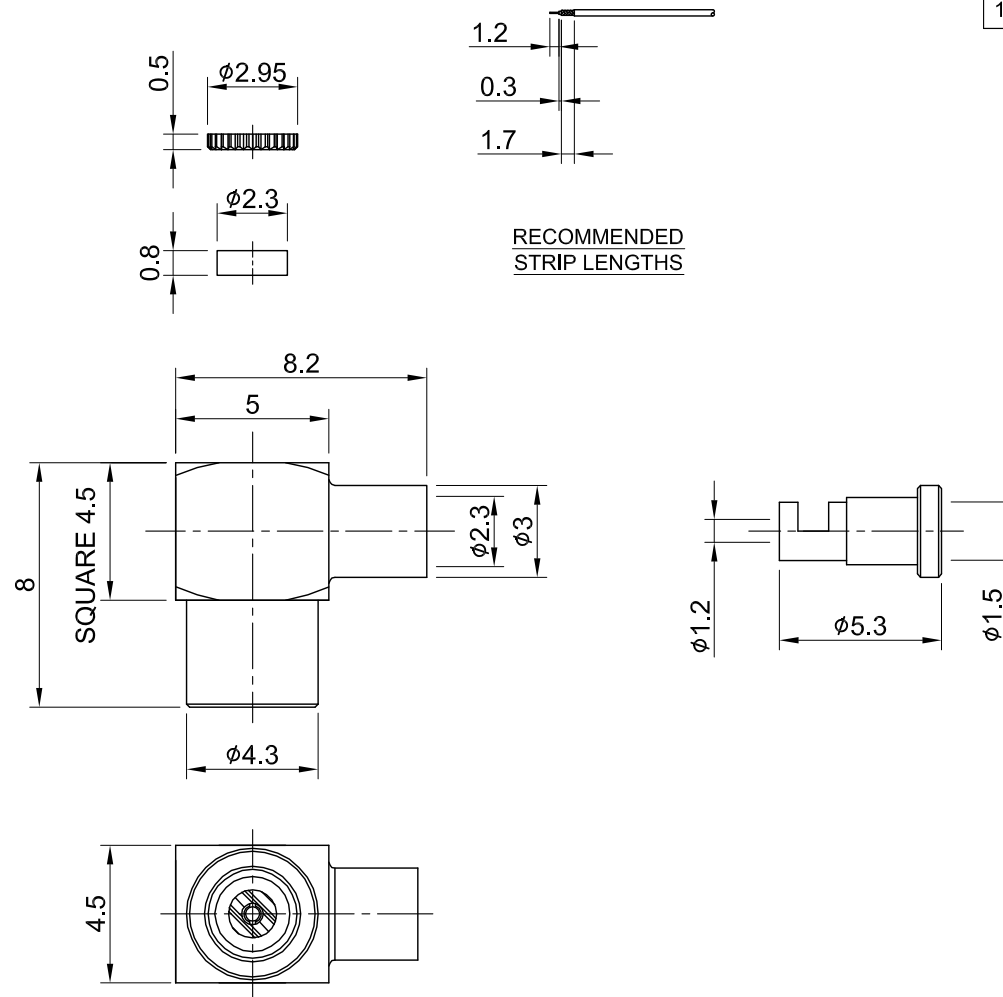

MECHANICAL DATA
 DURABILITY : 500 CYCLES
 TEMPERATURE RANGE : -40°C ~ + 85°C

ELECTRICAL DATA
 FREQUENCY RANGE: DC~6GHz
 IMPEDANCE : 50Ω
 VSWR : DC~3.0GHz : 1.3 MAX.
 3.01~6.0GHz : 1.5 MAX
 WORKING VOLTAGE : AC 170V
 WITHSTANDING VOLTAGE : AC 500V
 INSULATION RESISTANCE : 1000 MΩ MIN

06	FERRULE	BRASS	GOLD	1
05	INSULATOR	TEFLON	NONE	1
04	CENTER PIN	Be.Cu	GOLD	1
03	BODY	BRASS	GOLD	1
02	INSULATOR COVER	POM	NONE	1
01	COVER	BRASS	GOLD	1
NO	DESCRIPTION	MATERIAL	FINISH	Q'TY

TITLE		DRAWN BY:		CHK'D BY:		REVISION	
MMCX(F) ra. for 1.32/1.32DS cable		Lottie	2023/11/14	Dora	2023/11/14	REV. 1.40	
DWG NO. C06BA3F132005B		DRAWN BY: Lottie 2023/11/14		CHK'D BY: Dora 2023/11/14		REV. 1.40	
CUST. P/N: N/A		DRAWN BY: Lottie 2023/11/14		CHK'D BY: Dora 2023/11/14		REV. 1.40	
DWG NO: N/A		DRAWN BY: Lottie 2023/11/14		CHK'D BY: Dora 2023/11/14		REV. 1.40	
SHEET 1 of 1		DRAWN BY: Lottie 2023/11/14		CHK'D BY: Dora 2023/11/14		REV. 1.40	
Unit: mm		DRAWN BY: Lottie 2023/11/14		CHK'D BY: Dora 2023/11/14		REV. 1.40	

Wellshow

GENERAL TOLERANCES

.X ±0.2

.XX ±0.2

.XXX ±0.2

ANGLES N/A

DRAWN BY: Lottie 2023/11/14

CHK'D BY: Dora 2023/11/14

REV. 1.40

DA2311090008