

REV	DESCRIPTION	DATE
1.30	NEW DRAWING FRAME	2023/08/31
1.31	CORRECT INSULATION RESISTANCE UNIT	2023/08/31

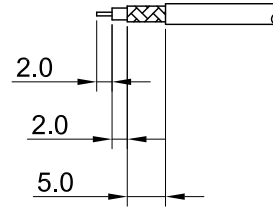

RECOMMENDED STRIP LENGTHS

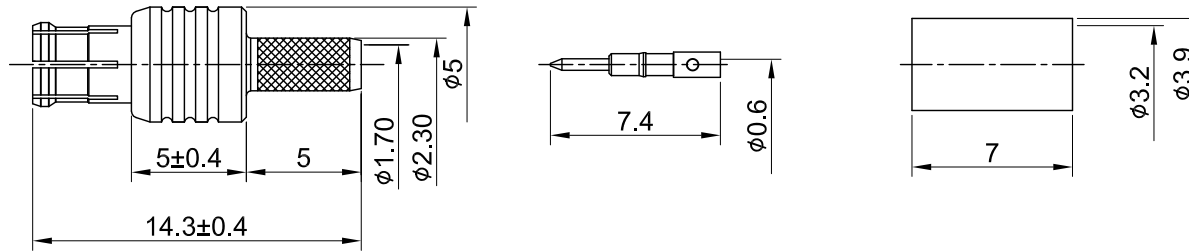

MECHANICAL DATA
TEMPERATURE RANGE : -65°C ~ + 165°C

ELECTRICAL DATA
FREQUENCY RANGE: DC~6GHz
IMPEDANCE : 50Ω
VSWR : 1.3 MAX.
WORKING VOLTAGE : AC 335V
WITHSTANDING VOLTAGE : AC 500V
INSULATION RESISTANCE : 1000 MΩ MIN

05	FERRULE	BRASS	GOLD	1
04	BODY B	BRASS	GOLD	1
03	CENTER PIN	BRASS	GOLD	1
02	INSULATOR	TEFLON	NONE	1
01	BODY A	Be.Cu	GOLD	1
NO	DESCRIPTION	MATERIAL	FINISH	Q'TY

TITLE		DRAWN BY:		CHK'D BY:		REVISION	
MCX(M) st. crimp for RD316		Kelly		Chili		REV.	
DWG NO. C07AA31316D04		2024/01/16		2024/01/16		1.31	
CUST. P/N: N/A DWG NO: N/A		GENERAL TOLERANCES		DRAWN BY: Kelly		CHK'D BY: Chili	
SHEET 1 of 1 Unit: mm		.X ±0.2 .XX ±0.2 .XXX ±0.2 ANGLES N/A		DA2312270056		1.31	

