

REV	DESCRIPTION	DATE
1.50	NEW DRAWING FRAME	2023/08/30
1.51	CORRECT INSULATION RESISTANCE UNIT	2024/01/16

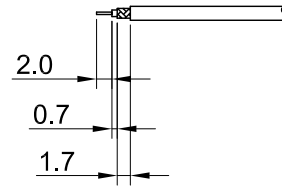

RECOMMENDED STRIP LENGTHS

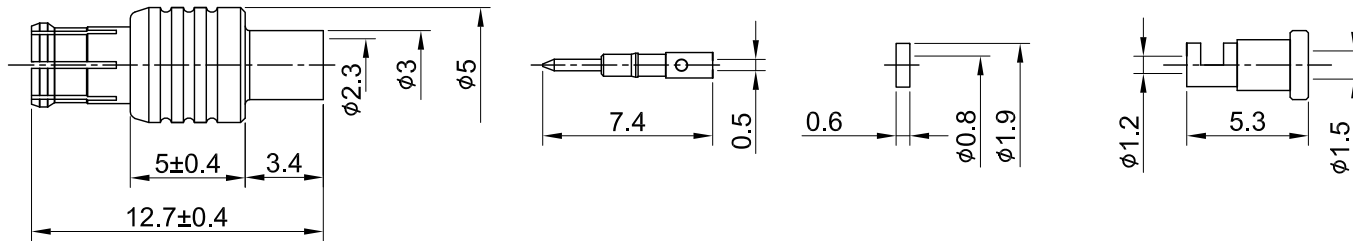

MECHANICAL DATA
TEMPERATURE RANGE : -65°C ~ + 165°C

ELECTRICAL DATA
FREQUENCY RANGE: DC~6GHZ
IMPEDANCE : 50Ω
VSWR : 1.3 MAX.
WORKING VOLTAGE : AC 335V
WITHSTANDING VOLTAGE : AC 500V
INSULATION RESISTANCE : 1000 MΩ MIN

06	FERRULE	BRASS	GOLD	1
05	GASKET	TEFLON	NONE	1
04	BODY B	BRASS	GOLD	1
03	CENTER PIN	BRASS	GOLD	1
02	INSULATOR	TEFLON	NONE	1
01	BODY A	Be.Cu	GOLD	1
NO	DESCRIPTION	MATERIAL	FINISH	Q'TY

TITLE		DRAWN BY:		CHK'D BY:		REVISION	
MCX(M) st. crimp type for 1.32/1.32DS cable		Kelly		Chili		2024/01/16	
DWG NO. C07AA31132004A		DRAWN BY: Kelly		CHK'D BY: Chili		2024/01/16	
CUST. P/N: N/A		DRAWN BY: Kelly		CHK'D BY: Chili		2024/01/16	
DWG NO: N/A		DRAWN BY: Kelly		CHK'D BY: Chili		2024/01/16	
SHEET 1 of 1		Unit: mm		DA2312270050		REV. 1.51	



GENERAL TOLERANCES		DRAWN BY:		CHK'D BY:		REVISION	
.X	±0.2	Kelly		Chili		2024/01/16	
.XX	±0.2	Kelly		Chili		2024/01/16	
.XXX	±0.2	Kelly		Chili		2024/01/16	
ANGLES	N/A	Kelly		Chili		2024/01/16	