

REV	DESCRIPTION	DATE
1.50	NEW DRAWING FRAME	2023/08/30

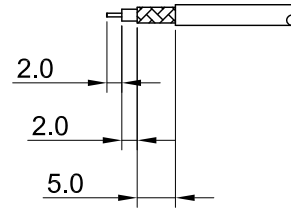

RECOMMENDED STRIP LENGTHS

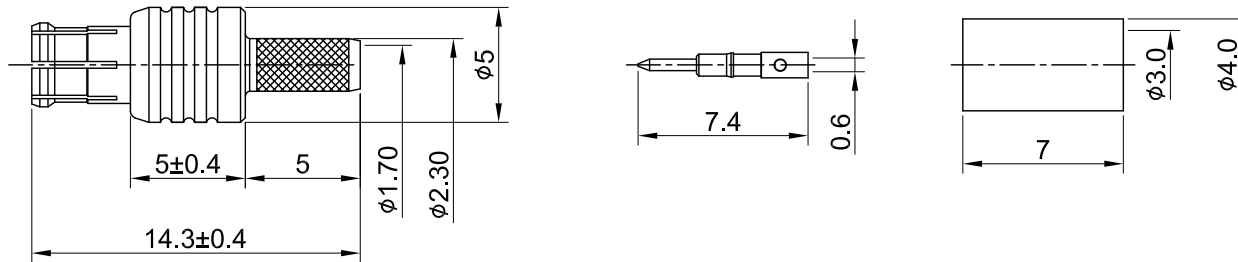

MECHANICAL DATA  
TEMPERATURE RANGE : -65°C ~ + 165°C

ELECTRICAL DATA  
FREQUENCY RANGE: DC~6GHz  
IMPEDANCE : 50Ω  
VSWR : 1.3 MAX.  
WORKING VOLTAGE : AC 335V  
WITHSTANDING VOLTAGE : AC 500V  
INSULATION RESISTANCE : 1000 MΩ MIN

05	FERRULE	BRASS	GOLD	1
04	BODY B	BRASS	GOLD	1
03	PIN	BRASS	GOLD	1
02	INSULATOR	TEFLON	NONE	1
01	BODY A	Be.Cu	GOLD	1
NO	DESCRIPTION	MATERIAL	FINISH	Q'TY

TITLE  
MCX(M) st. crimp type for RG174

DWG NO. C07AA31174004	
CUST. P/N: N/A DWG NO: N/A	
SHEET 1 of 1	Unit: mm

GENERAL TOLERANCES

.X	±0.2
.XX	±0.2
.XXX	±0.2
ANGLES	N/A

DRAWN BY: Kelly 2023/08/30

CHK'D BY: Eileen 2023/08/30

REV. 1.50

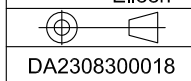

DA2308300018