

REV	DESCRIPTION	DATE
1.00	INITIAL DESIGN	2018/04/09
1.10	NEW DRAWING FRAME	2024/12/30

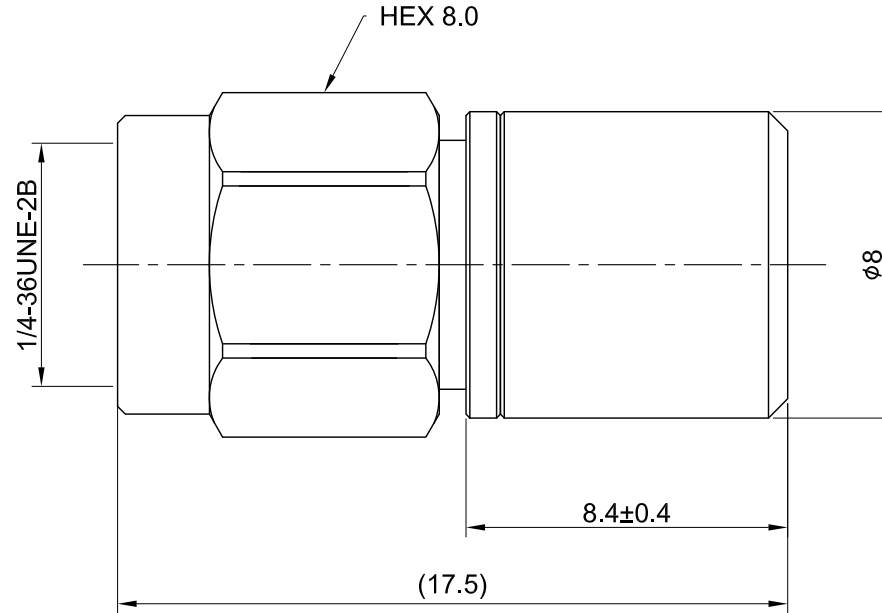

MECHANICAL DATA  
TEMPERATURE RANGE : -65°C ~ + 165°C

ELECTRICAL DATA  
FREQUENCY RANGE: DC~6GHz  
IMPEDANCE : 50Ω  
VSWR : 1.3 MAX.  
WORKING VOLTAGE : AC 500V  
INSULATION RESISTANCE : 5000 MΩ MIN

08	RETAINING HOLDER	BRASS	GOLD	1	TITLE SMA(M) st. terminator, 50ohm, 6GHz, 0.5W, Gold
07	CENTER PIN	BRASS	GOLD	1	
06	TRIMMABLE CHIP RESISTOR	NONE	NONE	2	
05	INSULATOR	TEFLON	NONE	1	DWG NO. C99AA3F20
04	BODY	BRASS	GOLD	1	CUST. P/N: N/A DWG NO: N/A
03	INNER RETAINING RING	STAINLESS STEEL	NONE	1	
02	GASKET	SILICONE RUBBER	RED	1	
01	SHELL	BRASS	GOLD	1	SHEET 1 of 1 Unit: mm
NO	DESCRIPTION	MATERIAL	FINISH	Q'TY	

GENERAL TOLERANCES

.X ±0.2  
.XX ±0.2  
.XXX ±0.2  
ANGLES N/A

DRAWN BY: Kelly 2024/12/30

CHK'D BY: Mindy 2024/12/30

REV. 1.10





DA2412300004